



**CAPACITORS, FIXED, SELF-HEALING,
NON-INDUCTIVE,
POLYETHYLENE TEREPHTALATE DIELECTRIC**

BASED ON TYPE PM907S

ESCC Detail Specification No. 3006/025

Issue 6	April 2023
---------	------------



LEGAL DISCLAIMER AND COPYRIGHT

European Space Agency, Copyright © 2023. All rights reserved.

The European Space Agency disclaims any liability or responsibility, to any person or entity, with respect to any loss or damage caused, or alleged to be caused, directly or indirectly by the use and application of this ESCC publication.

This publication, without the prior permission of the European Space Agency and provided that it is not used for a commercial purpose, may be:

- copied in whole, in any medium, without alteration or modification.
- copied in part, in any medium, provided that the ESCC document identification, comprising the ESCC symbol, document number and document issue, is removed.

DOCUMENTATION CHANGE NOTICE

(Refer to <https://escies.org> for ESCC DCR content)

DCR No.	CHANGE DESCRIPTION
1521 , 1522 , 1558 , 1565	Specification updated to incorporate changes per DCR.

TABLE OF CONTENTS

1	GENERAL	5
1.1	SCOPE	5
1.2	APPLICABLE DOCUMENTS	5
1.3	TERMS, DEFINITIONS, ABBREVIATIONS, SYMBOLS AND UNITS	5
1.4	THE ESCC COMPONENT NUMBER AND COMPONENT TYPE VARIANTS	5
1.4.1	The ESCC Component Number	5
1.4.1.1	Characteristics and Ratings Codes	5
1.4.2	Component Type Variants and Range of Components	6
1.4.2.1	Component Type Variants	6
1.4.2.2	Range of Components	6
1.5	MAXIMUM RATINGS	14
1.6	PHYSICAL DIMENSIONS AND TERMINAL IDENTIFICATION	15
1.6.1	Component Type Variants 01 to 08 (PM907S)	15
1.6.2	Component Type Variants 09 to 16 (PM907SR1)	16
1.6.3	Component Type Variants 17 to 24 (PM907SR2)	17
1.6.4	Component Type Variants 25 to 29 (PM907NS with 2 Rows of 7 Terminals)	18
1.6.5	Component Type Variants 30 to 32 (PM907NS with 2 Rows of 11 Terminals)	19
1.7	FUNCTIONAL DIAGRAM	19
1.8	MATERIALS AND FINISHES	20
1.8.1	Lead/Terminal Material	20
1.8.2	Lead/Terminal Finish	20
2	REQUIREMENTS	20
2.1	GENERAL	20
2.1.1	Deviations from the Generic Specification	20
2.1.1.1	Deviations from Qualification and Periodic Tests – Chart F4	20
2.2	MARKING	20
2.3	ROBUSTNESS OF TERMINATIONS	21
2.4	ELECTRICAL MEASUREMENTS AT ROOM, HIGH AND LOW TEMPERATURES	21
2.4.1	Room Temperature Electrical Measurements	21
2.4.2	High and Low Temperatures Electrical Measurements	22
2.5	INTERMEDIATE AND END-POINT ELECTRICAL MEASUREMENTS	22
2.6	BURN-IN CONDITIONS	24
	APPENDIX 'A'	25

1 GENERAL

1.1 SCOPE

This specification details the ratings, physical and electrical characteristics, and test and inspection data for the component type variants and/or the Component Type Variants and Range of Components specified below. It supplements the requirements of, and shall be read in conjunction with, the ESCC Generic Specification listed under Applicable Documents.

1.2 APPLICABLE DOCUMENTS

The following documents form part of this specification and shall be read in conjunction with it:

- (a) ESCC Generic Specification No. [3006](#).

1.3 TERMS, DEFINITIONS, ABBREVIATIONS, SYMBOLS AND UNITS

For the purpose of this specification, the terms, definitions, abbreviations, symbols and units specified in ESCC Basic Specification No. [21300](#) shall apply.

1.4 THE ESCC COMPONENT NUMBER AND COMPONENT TYPE VARIANTS

1.4.1 The ESCC Component Number

The ESCC Component Number shall be constituted as follows:

Example: 300602501155KH

- Detail Specification Reference: 3006025
- Component Type Variant Number: 01 (as required)
- Characteristic code: Capacitance Value (1.5µF): 155 (as required)
- Characteristic code: Capacitance Tolerance (±10%): K (as required)
- Rating code: Rated Voltage (250V): H (as required)

1.4.1.1 Characteristics and Ratings Codes

Characteristics and ratings to be codified as part of the ESCC Component Number shall be as follows:

- (a) Capacitance Value, C, expressed by means of the following codes in accordance with ESCC Basic Specification No. [21700](#). The unit quantity shall be picofarads (pF).

Capacitance Value C (pF)	Code
XX 10 ³	XX3
XX 10 ⁴	XX4
XX 10 ⁵	XX5
XX 10 ⁶	XX6
XX 10 ⁷	XX7

- (b) Capacitance Tolerance expressed by the following codes in accordance with ESCC Basic Specification No. [21700](#):

Tolerance (± %)	Code Letter
10	K
20	M

(c) DC Rated Voltage, U_R , expressed by the following codes:

DC Rated Voltage U_R (V)	Code Letter
50	C
63	D
100	E
170	F
200	G
250	H
400	K
500	L
630	Z
800	P
1000	Q
1250	R

1.4.2 Component Type Variants and Range of Components

1.4.2.1 *Component Type Variants*

32 Component Type Variants are defined in this specification and five different package types are available, as follows:

- Radial lead package: Component Type Variants 01 to 08
- Surface mount package with tab-type terminations: Component Type Variants 09 to 16
- Surface mount package with bar-type terminals: Component Type Variants 17 to 24
- Plug-in package with 2 rows of 7 terminals: Component Type Variants 25 to 29
- Plug-in package with 2 rows of 11 terminals: Component Type Variants 30 to 32

A number of different sizes are therefore available for each package type. See Para. 1.6 for details.

1.4.2.2 *Range of Components*

The range of components applicable to this specification are as follows:

DC Rated Voltage (U_R) Max (V) (Note 1)	Capacitance Value C (μ F) (Note 2)	AC Rated Current (I_{RA}) Max (Arms)	Available Type Variants (See Para. 1.6) (Note 1)	Weight Max (g)
50	15	5.2	01, 09, 17, 25	4.9
50	18	6.2	02, 10, 18, 26	6
50	22	7.6	02, 10, 18, 26	6
50	27	9.4	03, 11, 19, 27	9.5
50	33	11.5	03, 11, 19, 27	9.5
50	47	12.5	04, 12, 20, 28	13.6
50	56	12.5	04, 12, 20, 28	13.6
50	68	12.5	04, 12, 20, 28	13.6
50	82	12.5	05, 13, 21, 29	20.4

DC Rated Voltage (U_R) Max (V) (Note 1)	Capacitance Value C (μ F) (Note 2)	AC Rated Current (I_{RA}) Max (Arms)	Available Type Variants (See Para. 1.6) (Note 1)	Weight Max (g)
50	100	12.5	05, 13, 21, 29	20.4
63	8.2	3.2	01, 09, 17, 25	4.9
63	10	4	01, 09, 17, 25	4.9
63	12	5	01, 09, 17, 25	4.9
63	15	6.3	02, 10, 18, 26	6
63	18	7.6	03, 11, 19, 27	9.5
63	22	8	03, 11, 19, 27	9.5
63	27	10	04, 12, 20, 28	13.6
63	33	10	04, 12, 20, 28	13.6
63	39	11.8	04, 12, 20, 28	13.6
63	39	8.5	06, 14, 22, 30	21.2
63	47	12.5	05, 13, 21, 29	20.4
63	47	10.3	06, 14, 22, 30	21.2
63	56	12.5	05, 13, 21, 29	20.4
63	56	12.2	06, 14, 22, 30	21.2
63	68	15	07, 15, 23, 31	37.3
63	82	15	07, 15, 23, 31	37.3
63	100	15	07, 15, 23, 31	37.3
63	120	15	07, 15, 23, 31	37.3
63	150	15	08, 16, 24, 32	54.2
63	180	15	08, 16, 24, 32	54.2
100	4.7	2.5	01, 09, 17, 25	4.9
100	5.6	3.2	01, 09, 17, 25	4.9
100	6.8	4.3	01, 09, 17, 25	4.9
100	8.2	5.2	01, 09, 17, 25	4.9
100	10	6.4	02, 10, 18, 26	6
100	12	6.4	03, 11, 19, 27	9.5
100	15	8	03, 11, 19, 27	9.5
100	18	8	03, 11, 19, 27	9.5
100	22	8	03, 11, 19, 27	9.5
100	27	10	04, 12, 20, 28	13.6
100	33	10	04, 12, 20, 28	13.6
100	33	9.1	06, 14, 22, 30	21.2
100	39	12.5	05, 13, 21, 29	20.4
100	39	10.7	06, 14, 22, 30	21.2
100	47	12.5	05, 13, 21, 29	20.4
100	47	13	06, 14, 22, 30	21.2

DC Rated Voltage (U _R) Max (V) (Note 1)	Capacitance Value C (μF) (Note 2)	AC Rated Current (I _{RA}) Max (Arms)	Available Type Variants (See Para. 1.6) (Note 1)	Weight Max (g)
100	56	15	07, 15, 23, 31	37.3
100	68	15	07, 15, 23, 31	37.3
100	82	15	07, 15, 23, 31	37.3
100	100	15	07, 15, 23, 31	37.3
100	120	15	08, 16, 24, 32	54.2
100	150	15	08, 16, 24, 32	54.2
170	3.3	2	01, 09, 17, 25	4.9
170	3.9	2.5	01, 09, 17, 25	4.9
170	4.7	3.1	01, 09, 17, 25	4.9
170	5.6	4	02, 10, 18, 26	6
170	6.8	5	02, 10, 18, 26	6
170	8.2	6	03, 11, 19, 27	9.5
170	10	7.3	03, 11, 19, 27	9.5
170	12	8	04, 12, 20, 28	13.6
170	15	10	04, 12, 20, 28	13.6
170	18	10	04, 12, 20, 28	13.6
170	22	10	05, 13, 21, 29	20.4
170	22	7.7	06, 14, 22, 30	21.2
170	27	12.5	05, 13, 21, 29	20.4
170	27	9.5	06, 14, 22, 30	21.2
170	33	12.5	05, 13, 21, 29	20.4
170	33	11.4	06, 14, 22, 30	21.2
170	39	15	07, 15, 23, 31	37.3
170	47	15	07, 15, 23, 31	37.3
170	56	15	07, 15, 23, 31	37.3
170	68	15	08, 16, 24, 32	54.2
170	82	15	08, 16, 24, 32	54.2
170	100	15	08, 16, 24, 32	54.2
200	2.2	2	01, 09, 17, 25	4.9
200	2.7	2.4	01, 09, 17, 25	4.9
200	3.3	2.8	01, 09, 17, 25	4.9
200	3.9	3.5	02, 10, 18, 26	6
200	4.7	4	02, 10, 18, 26	6
200	5.6	5	03, 11, 19, 27	9.5
200	6.8	6	03, 11, 19, 27	9.5
200	8.2	7	03, 11, 19, 27	9.5
200	10	7.5	04, 12, 20, 28	13.6

DC Rated Voltage (U_R) Max (V) (Note 1)	Capacitance Value C (μ F) (Note 2)	AC Rated Current (I_{RA}) Max (Arms)	Available Type Variants (See Para. 1.6) (Note 1)	Weight Max (g)
200	12	9.5	04, 12, 20, 28	13.6
200	15	10	05, 13, 21, 29	20.4
200	15	7.1	06, 14, 22, 30	21.2
200	18	12.5	05, 13, 21, 29	20.4
200	18	8.9	06, 14, 22, 30	21.2
200	22	12.5	05, 13, 21, 29	20.4
200	22	10.1	06, 14, 22, 30	21.2
200	27	15	07, 15, 23, 31	37.3
200	33	15	07, 15, 23, 31	37.3
200	39	15	07, 15, 23, 31	37.3
200	47	15	08, 16, 24, 32	54.2
200	56	15	08, 16, 24, 32	54.2
200	68	15	08, 16, 24, 32	54.2
250	1.5	1.5	01, 09, 17, 25	4.9
250	2.2	2.2	01, 09, 17, 25	4.9
250	2.7	2.4	01, 09, 17, 25	4.9
250	3.3	2.6	02, 10, 18, 26	6
250	3.9	3.1	03, 11, 19, 27	9.5
250	4.7	3.7	03, 11, 19, 27	9.5
250	5.6	4.4	03, 11, 19, 27	9.5
250	6.8	5.4	04, 12, 20, 28	13.6
250	8.2	6.5	04, 12, 20, 28	13.6
250	10	7.9	04, 12, 20, 28	13.6
250	12	9.5	05, 13, 21, 29	20.4
250	12	5.4	06, 14, 22, 30	21.2
250	15	11.9	05, 13, 21, 29	20.4
250	15	6.7	06, 14, 22, 30	21.2
250	18	12.5	05, 13, 21, 29	20.4
250	18	8.1	06, 14, 22, 30	21.2
250	22	9.9	07, 15, 23, 31	37.3
250	27	12.1	07, 15, 23, 31	37.3
250	33	14.9	07, 15, 23, 31	37.3
250	39	15	08, 16, 24, 32	54.2
250	47	15	08, 16, 24, 32	54.2
250	56	15	08, 16, 24, 32	54.2
400	0.82	2.5	01, 09, 17, 25	4.9
400	1	3.1	01, 09, 17, 25	4.9

DC Rated Voltage (U_R) Max (V) (Note 1)	Capacitance Value C (μ F) (Note 2)	AC Rated Current (I_{RA}) Max (Arms)	Available Type Variants (See Para. 1.6) (Note 1)	Weight Max (g)
400	1.2	3.2	02, 10, 18, 26	6
400	1.5	4	02, 10, 18, 26	6
400	1.8	4	03, 11, 19, 27	9.5
400	2.2	4.5	03, 11, 19, 27	9.5
400	2.7	5	03, 11, 19, 27	9.5
400	3.3	5	04, 12, 20, 28	13.6
400	3.9	5.9	04, 12, 20, 28	13.6
400	4.7	7.1	04, 12, 20, 28	13.6
400	5.6	7.9	05, 13, 21, 29	20.4
400	5.6	6.3	06, 14, 22, 30	21.2
400	6.8	9.6	05, 13, 21, 29	20.4
400	6.8	7.6	06, 14, 22, 30	21.2
400	8.2	11.5	05, 13, 21, 29	20.4
400	8.2	9.2	06, 14, 22, 30	21.2
400	10	11.2	07, 15, 23, 31	37.3
400	12	13.4	07, 15, 23, 31	37.3
400	15	15	07, 15, 23, 31	37.3
400	18	15	08, 16, 24, 32	54.2
400	22	15	08, 16, 24, 32	54.2
500	0.39	1.1	01, 09, 17, 25	4.9
500	0.47	1.3	01, 09, 17, 25	4.9
500	0.56	1.5	01, 09, 17, 25	4.9
500	0.68	1.9	01, 09, 17, 25	4.9
500	0.82	2.3	02, 10, 18, 26	6
500	1	2.8	02, 10, 18, 26	6
500	1.2	3.3	03, 11, 19, 27	9.5
500	1.5	4.2	03, 11, 19, 27	9.5
500	1.8	5	04, 12, 20, 28	13.6
500	2.2	6.3	04, 12, 20, 28	13.6
500	2.7	6.3	04, 12, 20, 28	13.6
500	3.3	6.3	05, 13, 21, 29	20.4
500	3.3	4.5	06, 14, 22, 30	21.2
500	3.9	8	05, 13, 21, 29	20.4
500	3.9	5.3	06, 14, 22, 30	21.2
500	4.7	8	05, 13, 21, 29	20.4
500	4.7	6.4	06, 14, 22, 30	21.2
500	5.6	7.9	07, 15, 23, 31	37.3
500	6.8	9.6	07, 15, 23, 31	37.3

DC Rated Voltage (U_R) Max (V) (Note 1)	Capacitance Value C (μ F) (Note 2)	AC Rated Current (I_{RA}) Max (Arms)	Available Type Variants (See Para. 1.6) (Note 1)	Weight Max (g)
500	8.2	11.5	07, 15, 23, 31	37.3
500	10	14	07, 15, 23, 31	37.3
500	12	15	08, 16, 24, 32	54.2
500	15	15	08, 16, 24, 32	54.2
630	0.22	0.8	01, 09, 17, 25	4.9
630	0.27	0.9	01, 09, 17, 25	4.9
630	0.33	1.1	01, 09, 17, 25	4.9
630	0.39	1.3	01, 09, 17, 25	4.9
630	0.47	1.6	02, 10, 18, 26	6
630	0.56	2	02, 10, 18, 26	6
630	0.68	2.5	03, 11, 19, 27	9.5
630	0.82	3	03, 11, 19, 27	9.5
630	1	3.2	03, 11, 19, 27	9.5
630	1.2	3.9	04, 12, 20, 28	13.6
630	1.5	5	04, 12, 20, 28	13.6
630	1.8	5.8	04, 12, 20, 28	13.6
630	2.2	7.2	05, 13, 21, 29	20.4
630	2.2	3.9	06, 14, 22, 30	21.2
630	2.7	8.8	05, 13, 21, 29	20.4
630	2.7	4.8	06, 14, 22, 30	21.2
630	3.3	10.8	05, 13, 21, 29	20.4
630	3.3	5.9	06, 14, 22, 30	21.2
630	3.9	7	07, 15, 23, 31	37.3
630	4.7	8.5	07, 15, 23, 31	37.3
630	5.6	10.1	07, 15, 23, 31	37.3
630	6.8	12.3	08, 16, 24, 32	54.2
630	8.2	14.7	08, 16, 24, 32	54.2
630	10	15	08, 16, 24, 32	54.2
800	0.22	0.9	01, 09, 17, 25	4.9
800	0.27	1.1	02, 10, 18, 26	6
800	0.33	1.4	02, 10, 18, 26	6
800	0.39	1.6	03, 11, 19, 27	9.5
800	0.47	1.9	03, 11, 19, 27	9.5
800	0.56	2.3	03, 11, 19, 27	9.5
800	0.68	2.8	03, 11, 19, 27	9.5
800	0.82	3.4	04, 12, 20, 28	13.6
800	1	4.1	04, 12, 20, 28	13.6

DC Rated Voltage (U_R) Max (V) (Note 1)	Capacitance Value C (μ F) (Note 2)	AC Rated Current (I_{RA}) Max (Arms)	Available Type Variants (See Para. 1.6) (Note 1)	Weight Max (g)
800	1	2.2	06, 14, 22, 30	21.2
800	1.2	5	05, 13, 21, 29	20.4
800	1.2	2.6	06, 14, 22, 30	21.2
800	1.5	6.2	05, 13, 21, 29	20.4
800	1.5	3.3	06, 14, 22, 30	21.2
800	1.8	4.3	07, 15, 23, 31	37.3
800	2.2	5.2	07, 15, 23, 31	37.3
800	2.7	6.4	07, 15, 23, 31	37.3
800	3.3	7.8	07, 15, 23, 31	37.3
800	3.9	9.2	08, 16, 24, 32	54.2
800	4.7	11	08, 16, 24, 32	54.2
800	5.6	12.5	08, 16, 24, 32	54.2
1000	0.15	0.8	02, 10, 18, 26	6
1000	0.22	1.1	02, 10, 18, 26	6
1000	0.27	1.4	03, 11, 19, 27	9.5
1000	0.33	1.7	03, 11, 19, 27	9.5
1000	0.39	3	03, 11, 19, 27	9.5
1000	0.47	2.5	04, 12, 20, 28	13.6
1000	0.56	2.9	04, 12, 20, 28	13.6
1000	0.68	3.4	04, 12, 20, 28	13.6
1000	0.68	1.9	06, 14, 22, 30	21.2
1000	0.82	4.3	05, 13, 21, 29	20.4
1000	0.82	2.3	06, 14, 22, 30	21.2
1000	1	5.2	05, 13, 21, 29	20.4
1000	1	2.9	06, 14, 22, 30	21.2
1000	1.2	3.4	07, 15, 23, 31	37.3
1000	1.5	4.3	07, 15, 23, 31	37.3
1000	1.8	5.1	07, 15, 23, 31	37.3
1000	2.2	6.2	07, 15, 23, 31	37.3
1000	2.7	7.7	08, 16, 24, 32	54.2
1000	3.3	9.4	08, 16, 24, 32	54.2
1000	3.9	11	08, 16, 24, 32	54.2
1250	0.082	0.5	02, 10, 18, 26	6
1250	0.1	0.7	02, 10, 18, 26	6
1250	0.12	0.8	03, 11, 19, 27	9.5
1250	0.15	1	03, 11, 19, 27	9.5
1250	0.18	1.2	03, 11, 19, 27	9.5

DC Rated Voltage (U _R) Max (V) (Note 1)	Capacitance Value C (μF) (Note 2)	AC Rated Current (I _{RA}) Max (Arms)	Available Type Variants (See Para. 1.6) (Note 1)	Weight Max (g)
1250	0.22	1.5	03, 11, 19, 27	9.5
1250	0.27	1.8	04, 12, 20, 28	13.6
1250	0.33	2.2	04, 12, 20, 28	13.6
1250	0.39	2.6	04, 12, 20, 28	13.6
1250	0.39	1.4	06, 14, 22, 30	21.2
1250	0.47	3.1	05, 13, 21, 29	20.4
1250	0.47	1.7	06, 14, 22, 30	21.2
1250	0.56	3.7	05, 13, 21, 29	20.4
1250	0.56	2	06, 14, 22, 30	21.2
1250	0.68	2.4	07, 15, 23, 31	37.3
1250	0.82	3	07, 15, 23, 31	37.3
1250	1	3.6	07, 15, 23, 31	37.3
1250	1.2	4.3	07, 15, 23, 31	37.3
1250	1.5	5.4	08, 16, 24, 32	37.3
1250	1.8	6.5	08, 16, 24, 32	54.2
1250	2.2	7.9	07, 15, 23, 31	54.2

NOTES:

- The allowable voltage variation for each combination of Type Variant and DC Rated Voltage is shown below:

ALLOWABLE VOLTAGE VARIATION dV/dt (V/μs)

Type Variants	DC Rated Voltage (U _R)											
	50V	63V	100V	170V	200V	250V	400V	500V	630V	800V	1000V	1250V
01 to 05 09 to 13 17 to 21 25 to 29	15	20	30	35	40	45	65	85	105	150	200	250
06, 07, 08 14, 15, 16 22, 23, 24 30, 31, 32	N/A	10	15	20	25	25	40	45	55	80	100	120

- Two Capacitance Tolerances are available:
 - ±20% for E6 Series Capacitance Values
 - ±10% for E12 Series Capacitance Values

1.5 MAXIMUM RATINGS

The maximum ratings shall not be exceeded at any time during use or storage.

Maximum ratings shall only be exceeded during testing to the extent specified in this specification and when stipulated in Test Methods and Procedures of the ESCC Generic Specification.

Characteristics	Symbols	Maximum Ratings	Units	Remarks
DC Rated Voltage	U_R	50, 63, 100, 170, 200, 250, 400, 500, 630, 800, 1000, 1250	V	Notes 1, 2
DC Category Voltage	U_C	Note 2	V	Over T_{op}
AC Current	I_{RA}	See Para. 1.4.2	Arms	f = 300kHz Note 3
Operating Temperature Range	T_{op}	-55 to +125	°C	T_{amb}
Storage Temperature Range	T_{stg}	-55 to +125	°C	
Soldering Temperature Variants 01 to 08 Variants 09 to 32	T_{sol}	+235 +260	°C	Notes 4, 5

NOTES:

- As required; See Para. 1.4.2.2.
- The DC Rated Voltage is also the DC Category Voltage when T_{op} is between -55°C (T_{amb}) and $+100^{\circ}\text{C}$ (T_{amb}). For $T_{op} > +100^{\circ}\text{C}$ (T_{amb}) only the DC Category Voltage applies, and derating must be observed as follows:
 - U_C derates linearly from $100\%U_C$ at $T_{amb} = +100^{\circ}\text{C}$ to $80\%U_C$ at $T_{amb} = +125^{\circ}\text{C}$.
- The AC Ripple Current I_{Ripple} (Arms) is $100\%I_{RA}$ when $-55^{\circ}\text{C} < T_{amb} \leq +105^{\circ}\text{C}$. For $T_{amb} > +105^{\circ}\text{C}$ derating of I_{Ripple} must be observed as follows:
 - I_{Ripple} derates linearly from $100\%I_{RA}$ at $T_{amb} = +105^{\circ}\text{C}$ to $10\%I_{RA}$ at $T_{amb} = +125^{\circ}\text{C}$.
- For Component Type Variants 01 to 08 and 25 to 32: Duration 5 seconds maximum at a distance of no less than 1mm from the body.
- For Component Type Variants 09 to 24: Duration 5 seconds maximum and only the bondable areas of the tab terminals shall be soldered.

1.6 PHYSICAL DIMENSIONS AND TERMINAL IDENTIFICATION

1.6.1 Component Type Variants 01 to 08 (PM907S)

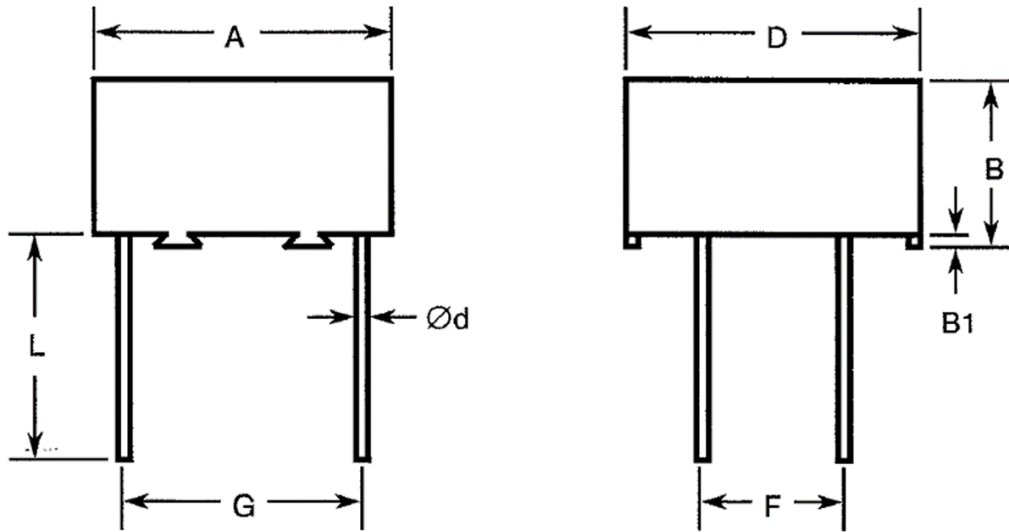

Type Variant	Dimensions (mm)												
	A		B	B1	D		Ød		F		G		L Min.
	Min.	Max.	Max.	Min.	Min.	Max.	Min.	Max.	Min.	Max.	Min.	Max.	
01	19.5	20.5	6.5	0.25	19.5	20.5	0.95	1.1	9.66	10.66	17.3	18.3	20
02	19.5	20.5	8	0.25	19.5	20.5	0.95	1.1	9.66	10.66	17.3	18.3	20
03	19.5	20.5	12.5	0.25	19.5	20.5	0.95	1.1	9.66	10.66	17.3	18.3	20
04	19.5	20.5	20	0.25	19.5	20.5	0.95	1.1	9.66	10.66	17.3	18.3	20
05	19.5	20.5	30	0.25	19.5	20.5	0.95	1.1	9.66	10.66	17.3	18.3	20
06	30.5	31.5	12.5	0.4	31.5	32.5	0.95	1.1	14.74	15.74	27.44	28.44	20
07	30.5	31.5	22	0.4	31.5	32.5	0.95	1.1	14.74	15.74	27.44	28.44	20
08	30.5	31.5	32	0.4	31.5	32.5	0.95	1.1	14.74	15.74	27.44	28.44	20

NOTES:

- Terminal identification: A voltage polarity “+” symbol shall be marked on the top of the body to indicate the row of terminals which should be connected to the highest potential.

1.6.2 Component Type Variants 09 to 16 (PM907SR1)

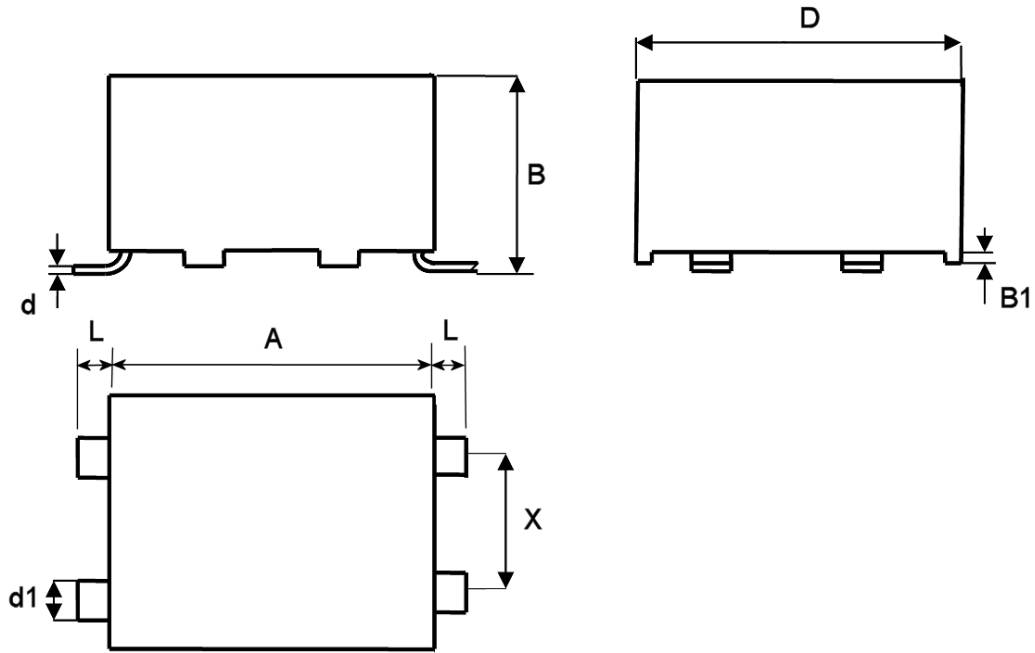

Type Variant	Dimensions (mm)													
	A		B		B1 Min.	D		d Max.	d1		X		L	
	Min.	Max.	Min.	Max.		Min.	Max.		Min.	Max.	Min.	Max.	Min.	Max.
09	19.5	20.5	6.5	7.5	0.25	19.5	20.5	0.3	2.45	2.75	9.5	10.5	2.75	3.25
10	19.5	20.5	8	9	0.25	19.5	20.5	0.3	2.45	2.75	9.5	10.5	2.75	3.25
11	19.5	20.5	12.5	13.5	0.25	19.5	20.5	0.3	2.45	2.75	9.5	10.5	2.75	3.25
12	19.5	20.5	20	21	0.25	19.5	20.5	0.3	2.45	2.75	9.5	10.5	2.75	3.25
13	19.5	20.5	30	31	0.25	19.5	20.5	0.3	2.45	2.75	9.5	10.5	2.75	3.25
14	30.5	31.5	12.5	13.5	0.4	31.5	32.5	0.3	3.95	4.4	14.5	15.5	2.75	3.25
15	30.5	31.5	22	23	0.4	31.5	32.5	0.3	3.95	4.4	14.5	15.5	2.75	3.25
16	30.5	31.5	32	33	0.4	31.5	32.5	0.3	3.95	4.4	14.5	15.5	2.75	3.25

NOTES:

1. Terminal identification: A voltage polarity “+” symbol shall be marked on the top of the body to indicate the row of terminals which should be connected to the highest potential.

1.6.3 Component Type Variants 17 to 24 (PM907SR2)

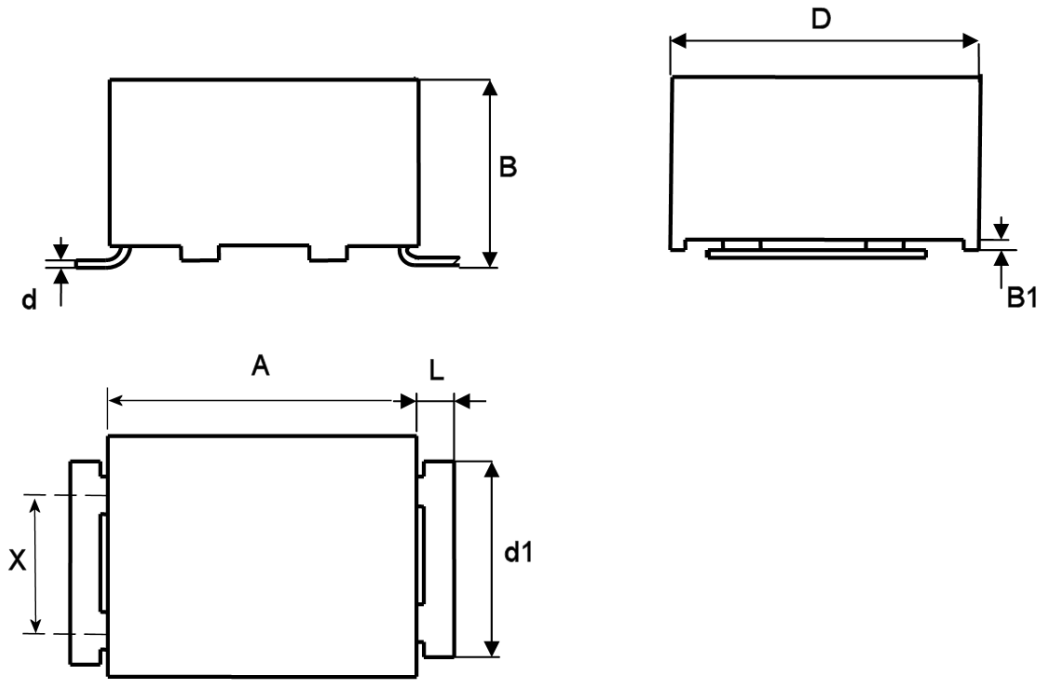

Type Variant	Dimensions (mm)													
	A		B		B1 Min.	D		d Max.	d1		X		L	
	Min.	Max.	Min.	Max.		Min.	Max.		Min.	Max.	Min.	Max.	Min.	Max.
17	19.5	20.5	6.5	7.5	0.25	19.5	20.5	0.3	14.5	15.5	9.5	10.5	2.75	3.25
18	19.5	20.5	8	9	0.25	19.5	20.5	0.3	14.5	15.5	9.5	10.5	2.75	3.25
19	19.5	20.5	12.5	13.5	0.25	19.5	20.5	0.3	14.5	15.5	9.5	10.5	2.75	3.25
20	19.5	20.5	20	21	0.25	19.5	20.5	0.3	14.5	15.5	9.5	10.5	2.75	3.25
21	19.5	20.5	30	31	0.25	19.5	20.5	0.3	14.5	15.5	9.5	10.5	2.75	3.25
22	30.5	31.5	12.5	13.5	0.4	31.5	32.5	0.3	23.5	24.5	14.5	15.5	2.75	3.25
23	30.5	31.5	22	23	0.4	31.5	32.5	0.3	23.5	24.5	14.5	15.5	2.75	3.25
24	30.5	31.5	32	33	0.4	31.5	32.5	0.3	23.5	24.5	14.5	15.5	2.75	3.25

NOTES:

- Terminal identification: A voltage polarity “+” symbol shall be marked on the top of the body to indicate the terminal which should be connected to the highest potential.

1.6.4 Component Type Variants 25 to 29 (PM907NS with 2 Rows of 7 Terminals)

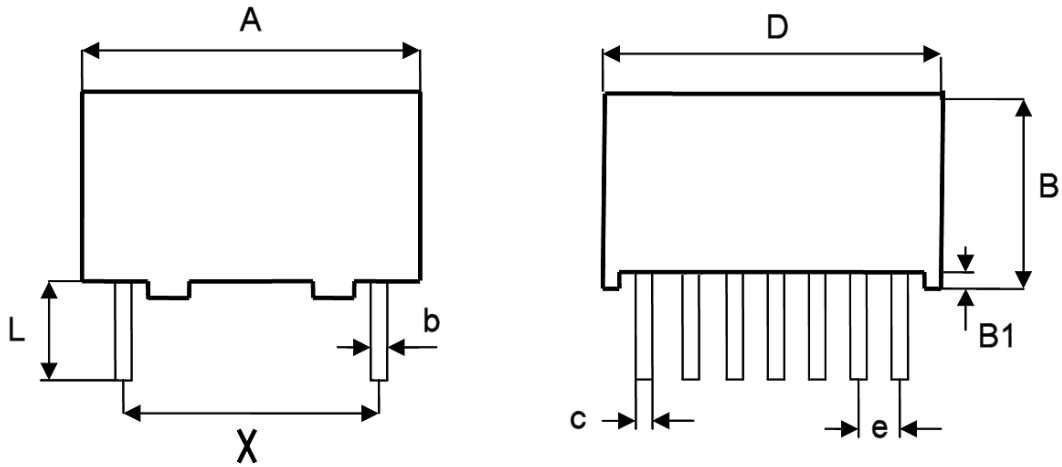

Type Variant	A		D		B Max.	B1 Min.	X		b		c		e		L Min.
	Min.	Max.	Min.	Max.			Min.	Max.	Min.	Max.	Min.	Max.	Min.	Max.	
25	19.5	20.5	19.5	20.5	6.5	0.25	17.3	18.3	0.15	0.35	0.4	0.6	2.34	2.74	5
26	19.5	20.5	19.5	20.5	8	0.25	17.3	18.3	0.15	0.35	0.4	0.6	2.34	2.74	5
27	19.5	20.5	19.5	20.5	12.5	0.25	17.3	18.3	0.15	0.35	0.4	0.6	2.34	2.74	5
28	19.5	20.5	19.5	20.5	20	0.25	17.3	18.3	0.15	0.35	0.4	0.6	2.34	2.74	5
29	19.5	20.5	19.5	20.5	30	0.25	17.3	18.3	0.15	0.35	0.4	0.6	2.34	2.74	5

NOTES:

- Terminal identification: A voltage polarity “+” symbol shall be marked on the top of the body to indicate the row of terminals which should be connected to the highest potential.

1.6.5 Component Type Variants 30 to 32 (PM907NS with 2 Rows of 11 Terminals)

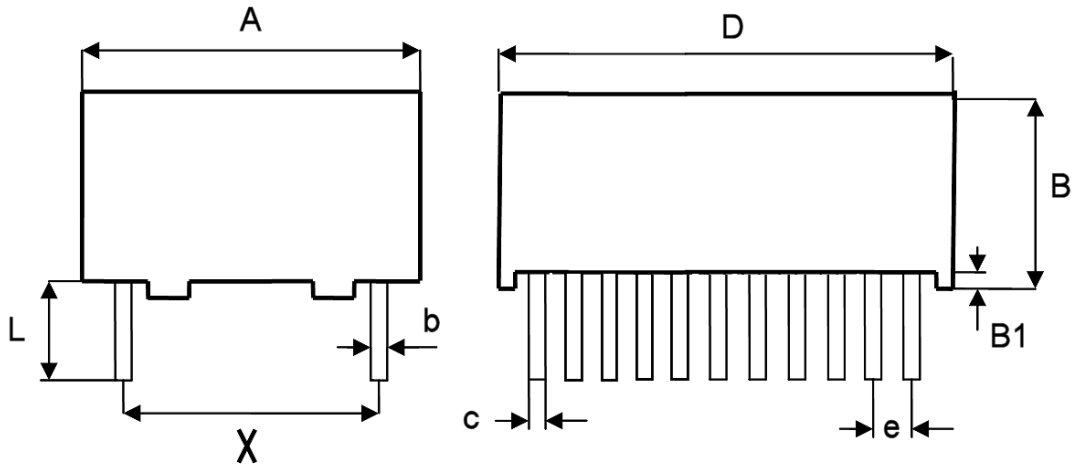

Type Variant	A		D		B Max.	B1 Min.	X		b		c		e		L Min.
	Min.	Max.	Min.	Max.			Min.	Max.	Min.	Max.	Min.	Max.	Min.	Max.	
30	30.5	31.5	31.5	32.5	12.5	0.4	27.44	28.44	0.15	0.35	0.4	0.6	2.34	2.74	5
31	30.5	31.5	31.5	32.5	22	0.4	27.44	28.44	0.15	0.35	0.4	0.6	2.34	2.74	5
32	30.5	31.5	31.5	32.5	32	0.4	27.44	28.44	0.15	0.35	0.4	0.6	2.34	2.74	5

NOTES:

- Terminal identification: A voltage polarity “+” symbol shall be marked on the top of the body to indicate the row of terminals which should be connected to the highest potential.

1.7 FUNCTIONAL DIAGRAM

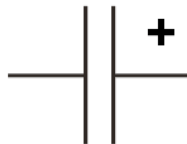

NOTES:

- These capacitors are not polarised; however, marking includes the voltage polarity symbol (see Para. 1.6) which should be respected in use.
- For Component Type Variants 01 to 16 and 25 to 32, each row of terminals is connected internally to a single electrode.

1.8 MATERIALS AND FINISHES

1.8.1 Lead/Terminal Material

The lead/terminal materials shall be as follows:

- Variants 01 to 08: Type A in accordance with the requirements of ESCC Basic Specification No. [23500](#).
- Variants 09 to 32: Brass.

1.8.2 Lead/Terminal Finish

The lead/terminal finishes shall be as follows:

- Variants 01 to 08: Type 19 in accordance with the requirements of ESCC Basic Specification No. [23500](#).
- Variants 09 to 32: Type 3 or Type 4 in accordance with the requirements of ESCC Basic Specification No. [23500](#).

2 REQUIREMENTS

2.1 GENERAL

The complete requirements for procurement of the components specified herein are as stated in this specification and the ESCC Generic Specification. Permitted deviations from the Generic Specification, applicable to this specification only, are listed below.

Permitted deviations from the Generic Specification and this Detail Specification, formally agreed with specific Manufacturers on the basis that the alternative requirements are equivalent to the ESCC requirement and do not affect the component's reliability, are listed in the appendices attached to this specification.

2.1.1 Deviations from the Generic Specification

2.1.1.1 *Deviations from Qualification and Periodic Tests – Chart F4*

- (a) Operating Life:
 - Test Condition (c), Applied voltage: $1.25 \times U_c$, where U_c is the applicable Category Voltage per Paras. 1.5 and 1.4.2.2.
- (b) Robustness of Terminations: for Component Type Variants 09 to 24 Robustness of Terminations shall be performed as follows:

The components shall be mounted on a suitable substrate. After mounting, examination shall be made for good tinning as evidenced by flowing of the solder with wetting of the terminations. A force of 10N shall be applied normal to the line joining the terminals and in a plane parallel to the substrate, for a duration of $10 \pm 1s$. The components shall then be examined and there shall be no evidence of damage or loosening of the components from the substrate.

2.2 MARKING

The marking shall be in accordance with the requirements of ESCC Basic Specification No. [21700](#) and as follows. The information to be marked on the component shall be:

- (a) Terminal Identification (see Para. 1.6).
- (b) The ESCC qualified components symbol (for ESCC qualified components only).
- (c) The ESCC Component Number (see Para. 1.4.1).
- (d) Traceability information.

2.3 ROBUSTNESS OF TERMINATIONS

The terminals of the components are rigid.

For Component Type Variants 01 to 08 and 25 to 32 the test conditions for Robustness of Terminations shall be as specified in the ESCC Generic Specification and as follows:

- Test Ua1, tensile:
 - Applied force for Component Type Variants 01 to 08: 10N
 - Applied force for Component Type Variants 25 to 32: 20N
 - Duration: 7.5 ±2.5s

All terminals of the component shall be tested.

2.4 ELECTRICAL MEASUREMENTS AT ROOM, HIGH AND LOW TEMPERATURES

Electrical measurements shall be performed at room, high and low temperatures.

2.4.1 Room Temperature Electrical Measurements

The measurements shall be performed at $T_{amb} = +22 \pm 3^{\circ}C$.

Characteristics	Symbols	Test Method and Conditions	Limits		Units
			Min	Max	
Capacitance	C	ESCC No. 3006 Test Frequency = 1kHz	Note 1	Note 2	μF
Tangent of Loss Angle	tgδ	ESCC No. 3006 Test Frequency = 1kHz	-	10×10 ⁻³	-
Insulation Resistance, Dielectric	R _i	ESCC No. 3006 C ≤ 0.33μF C > 0.33μF	7500	-	MΩ
			2500	-	MΩ.μF
Voltage Proof, Terminal-to-Terminal	VP	ESCC No. 3006	1.6×U _R (Note 3)	-	V

NOTES:

1. Capacitance Value of the component minus the applicable Tolerance (see Para. 1.4.2.2).
2. Capacitance Value of the component plus the applicable Tolerance (see Para. 1.4.2.2).
3. For the applicable Rated Voltage (U_R) see Para. 1.4.2.2.

2.4.2 High and Low Temperatures Electrical Measurements

Characteristics	Symbols	Test Method and Conditions (Note 1)	Limits		Units
			Min	Max	
Temperature Coefficient	$\Delta C/C$	ESCC No. 3006 Test Frequency = 1kHz $T_{amb} = -55 (+3 -0)^{\circ}C$	-	-10 (Note 2)	%
		$T_{amb} = +125 (+0 -3)^{\circ}C$	-	+18 (Note 2)	%

NOTES:

1. The measurements shall be performed on a sample of 6 components from each manufacturing lot with 0 failures allowed. In the event of any failure a 100% inspection may be performed.
2. The Temperature Coefficient limits are with respect to the capacitance at $+22 \pm 2^{\circ}C$ (reference point temperature).

2.5 INTERMEDIATE AND END-POINT ELECTRICAL MEASUREMENTS

Unless otherwise specified, the measurements shall be performed at $T_{amb} = +22 \pm 3^{\circ}C$.

Unless otherwise specified the test methods and test conditions shall be as per the corresponding test defined in Para. 2.4.1, Room Temperature Electrical Measurements.

Test Reference per ESCC No. 3006	Characteristics	Symbols	Limits		Units
			Min	Max	
Resistance to Soldering Heat Initial Measurements Final Measurements	Capacitance	C	Note 1		μF
	Capacitance	C	Note 1		μF
	Change in Capacitance	$\Delta C/C$	-3	+3	%
	Insulation Resistance, Dielectric $C \leq 0.33\mu F$ $C > 0.33\mu F$	R_i	Note 1	-	$M\Omega$
			Note 1	-	$M\Omega.\mu F$
Tangent of Loss Angle	$tg\delta$	-	Note 2	-	
Temperature Coefficient	Temperature Coefficient (Note 3)	$\Delta C/C$	Note 4		%
Rapid Change of Temperature Initial Measurements Final Measurements	Capacitance	C	Note 1		μF
	Capacitance	C	Note 1		μF
	Change in Capacitance	$\Delta C/C$	-3	+3	%
	Tangent of Loss Angle	$tg\delta$	-	Note 1	-

Test Reference per ESCC No. 3006	Characteristics	Symbols	Limits		Units
			Min	Max	
Climatic Sequence Initial Measurements Final Measurements	Capacitance	C	Note 1		μF
	Capacitance	C	Note 1		μF
	Change in Capacitance	ΔC/C	-3	+3	%
	Tangent of Loss Angle	tgδ	-	Note 2	-
	Voltage Proof, Terminal-to-Terminal	VP	Note 1	-	V
	Insulation Resistance, Dielectric	R _i			
		C ≤ 0.33μF C > 0.33μF		Note 5 Note 5	- -
Operating Life Initial Measurements Intermediate Measurements (1000 hours) Final Measurements (1000 or 2000 hours) (Note 6)	Capacitance	C	Note 1		μF
	Capacitance	C	Note 1		μF
	Change in Capacitance	ΔC/C	-5	+5	%
	Capacitance	C	Note 1		μF
	Change in Capacitance	ΔC/C	-5	+5	%
	Tangent of Loss Angle	tgδ	-	Note 2	-
	Insulation Resistance, Dielectric	R _i			
	C ≤ 0.33μF C > 0.33μF		Note 5 Note 5	- -	MΩ MΩ.μF

NOTES:

- As specified in Para. 2.4.1.
- 1.5× the limit specified in Para. 2.4.1.
- The test method and test conditions shall be as specified in Para. 2.4.2.
- As specified in Para. 2.4.2.
- 50% of the limit specified in Para. 2.4.1.
- 1000 hours is applicable to Periodic Testing for extension of qualification. 2000 hours is applicable to Qualification Testing, and to Periodic Testing for renewal of qualification after lapse.

2.6

BURN-IN CONDITIONS

Characteristics	Symbols	Conditions (Note 1)	Units
Ambient Temperature	T_{amb}	+125 (+0 -5)	°C
Test Voltage	V_T	$1.25 \times U_C$ (Note 2)	V

NOTES:

1. On completion of Burn-in the components shall be removed from the burn-in chamber and allowed to cool, under normal atmospheric conditions, for recovery for 24 ±2 hours.
2. U_C is the applicable Category Voltage; see Paras. 1.5 and 1.4.2.2.

APPENDIX 'A'**AGREED DEVIATIONS FOR EXXELIA TECHNOLOGIES (F)**

Items Affected	Description of Deviations
Para. 2.1.1, Deviations from the Generic Specification: Deviations from Screening Tests – Chart F3	If a particular lot is required to undergo testing in accordance with Chart F4 then the results of the Temperature Coefficient measurements, made during High and Low Temperatures Electrical Measurements on a sample of 6 randomly-selected capacitors, shall be recorded.
Para. 2.1.1.1, Deviations from Qualification and Periodic Tests – Chart F4	The Temperature Coefficient measurements recorded during Screening Tests may be used in lieu of the performance of the Temperature Coefficient test as specified in Subgroup 2B of Chart F4.