

**TABLE 1(a) - COMPONENT TYPE VARIANTS AND RANGE OF COMPONENTS**

Variants		Shell Size Note 1	Weight Max g Note 2	Mating Force N Max	Unmating Force	
Shell Finish					N Max	N Min
Nickel	Gold					
01	02	9	2	20	20	1.3
01	02	15	2.6	33	33	2
01	02	21	3.2	47	47	2.9
01	02	25	3.6	55	55	3.5
01	02	31	4.2	69	69	4.3
01	02	37	4.8	82	82	5.1

**NOTES:**

1. See Figures 2.1(a) and 2.1(b).
2. Weight without cables, floating eyelets, captive nut and contacts (see Para. 4.5.4.4). Add 0.4 grammes for connectors with floating mounts and 1 gramme for connectors with captive nuts. See Figures 2.3 and 2.4 for the weight of cable and ESCC Detail Specification No. 3401/078 for contact weights.

**TABLE 1(b) - MAXIMUM RATINGS**

No.	Characteristic	Symbol	Maximum Rating	Unit	Remarks
1	Working Voltage	$U_R$	150	Vrms	Note 1
2	Rated Current with: AWG26 and uninsulated solid wire AWG28 wire	$I_R$	2.5 1.5	A	Note 2
3	Operating Temperature Range	$T_{op}$	-55 to +125	°C	$T_{amb}$
4	Storage Temperature Range	$T_{stg}$	-65 to +125	°C	-

**NOTES:**

1. At Sea Level, between contacts, and contact and shell.  $U_R$  requires derating at altitudes above sea level. See Figure 1(a).
2.  $I_R$  requires derating if the number of carrying contacts in the connector is 2 or greater. See Figure 1(b).

[ AWG24 wire | | 3.5 | ]

**FIGURE 1 - PARAMETER DERATING INFORMATION**  
**FIGURE 1(a) - WORKING VOLTAGE VERSUS ALTITUDE**

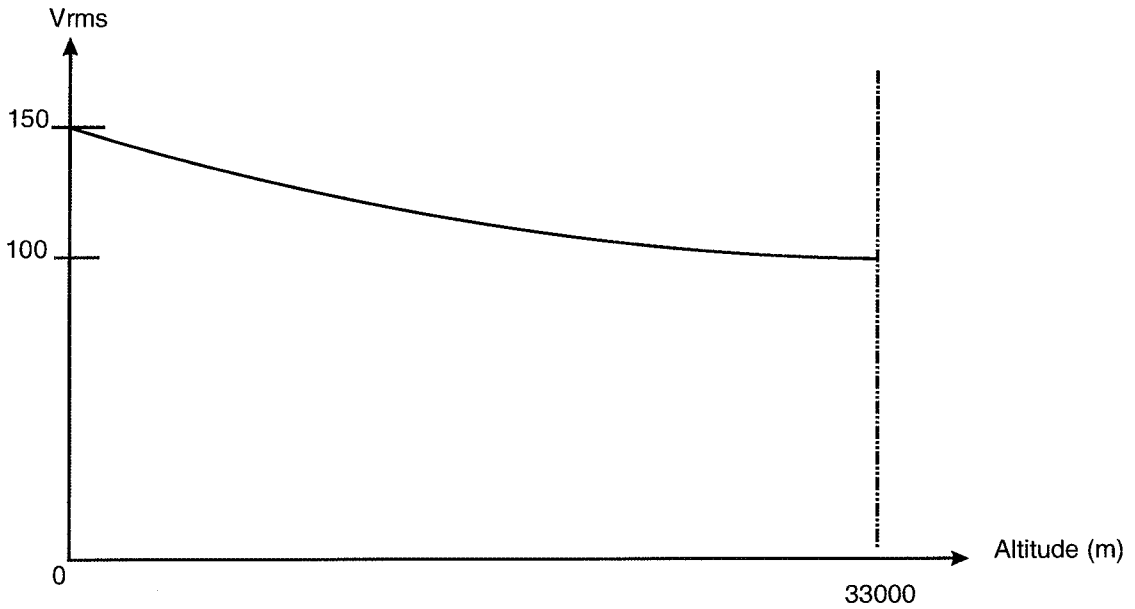

**FIGURE 1(b) - MAXIMUM CURRENT VERSUS NUMBER OF CONTACTS**

NUMBER OF CURRENT-CARRYING CONTACTS PER CONNECTOR	MAXIMUM CURRENT PER CONTACT (A)	
	WIRE SIZE	
	AWG26 AND UNINSULATED SOLID WIRE	AWG 28
2 - 4	2	1.4
5 - 14	1.8	1.2
15 and over	1.4	0.9

AWG24
2.6
2.4
1.9

**FIGURE 2 - PHYSICAL DIMENSIONS**

Figure 2.1(a) Connector Shells - Plug (Male Contacts)

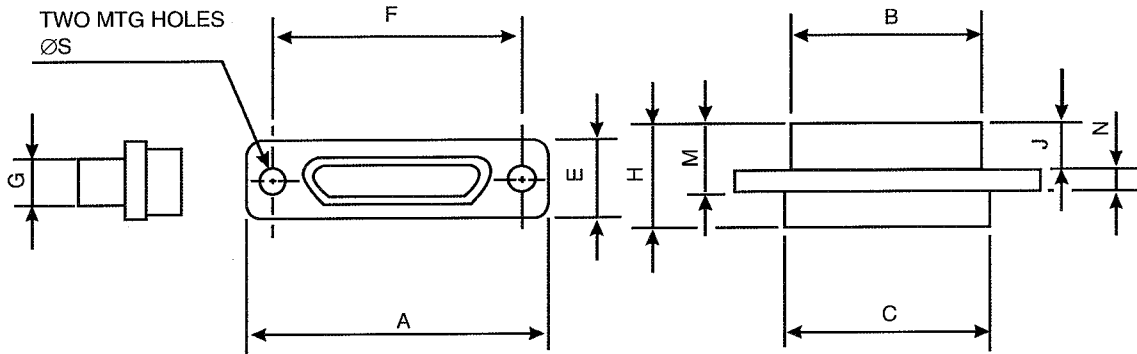

SHELL SIZE	A	B	C	D	E	E		G	H	J	M	N		Øs	
	Max	Max	Max	Max	Max	Min	Max	Max	Max	Max	Max	Min	Max	Min	Max
9	19.94	8.46	10.16	6.86	7.82	14.22	14.48	4.69	10.57	4.72	7.26	2.23	2.49	2.23	2.39

**FIGURE 2.3 - UNINSULATED SOLID WIRES ACCEPTED**

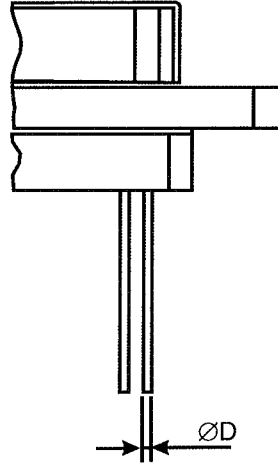

Wire Size AWG	25
Max Diameter D mm	0.46
Min Diameter D mm	0.45
Min Gold Plating Thickness $\mu\text{m}$	0.5
Max Weight g/m	1.6

**FIGURE 2.4 - INSULATED WIRES ACCEPTED**

		ESCC 3901/002		ESCC 3901/013	
		Wire Size AWG			
		26	28	26	28
Conductor Characteristics	Maximum Diameter mm	0.53	0.43	0.5	0.42
	Nominal Cross-section $\text{mm}^2$	0.15	0.1	0.14	0.1
Wire Characteristics	Maximum Diameter mm	0.78	0.68	0.89	0.82
	Maximum Weight g/m	1.93	1.23	2.3	1.8

