

TABLE 1(a) – TYPE VARIANTS

VARIANTS	DESIGNATION	TYPE	MAX. WEIGHT (g)	ACCEPTED CABLES
01	TRIAxIAL CONTACT	MALE	4.6	M17-176/00002 & SSQ-21655 (NDBC-TFE-2452SJ-75-1P512296-C)
02		FEMALE	7.2	
03	SEALING SLEEVE	STRAIGHT	2	M17-176/00002 & SSQ-21655 (NDBC-TFE-2452SJ-75-1P512296-C)
04		ELBOW	2	

NOTES

1. Contacts fitted in 09-01 arrangement shall be used only with backshells ESCC No. 3401/062, Variants 65 to 67.
2. Contacts fitted in other triax arrangements shall be used only with sealing sleeves ESCC No 3401/066, Variants 03 and backshells ESCC No 3401/062, Variants 41 to 45 or with sealing sleeves ESCC No 3401/066, Variants 04 and backshells ESCC No 3401/062, Variants 50 to 54

TABLE 1(b) – MAXIMUM RATINGS

No	CHARACTERISTICS	SYMBOL	MAXIMUM RATINGS	UNIT	REMARKS
1	Working Voltage Sea Level	Ur	500	V	
2	Rated Current	Icr	1.0	1A	
3	Frequency Range	f	0 to 20	MHz	Note 1
4	Operating Temperature Range	Top	- 65 to +200	°C	
5	Storage Temperature Range	Tstg	- 65 to +200	°C	

NOTES

1. Compatible with 1553 Bus Line

VARIANT 03 , STRAIGHT SLEEVE

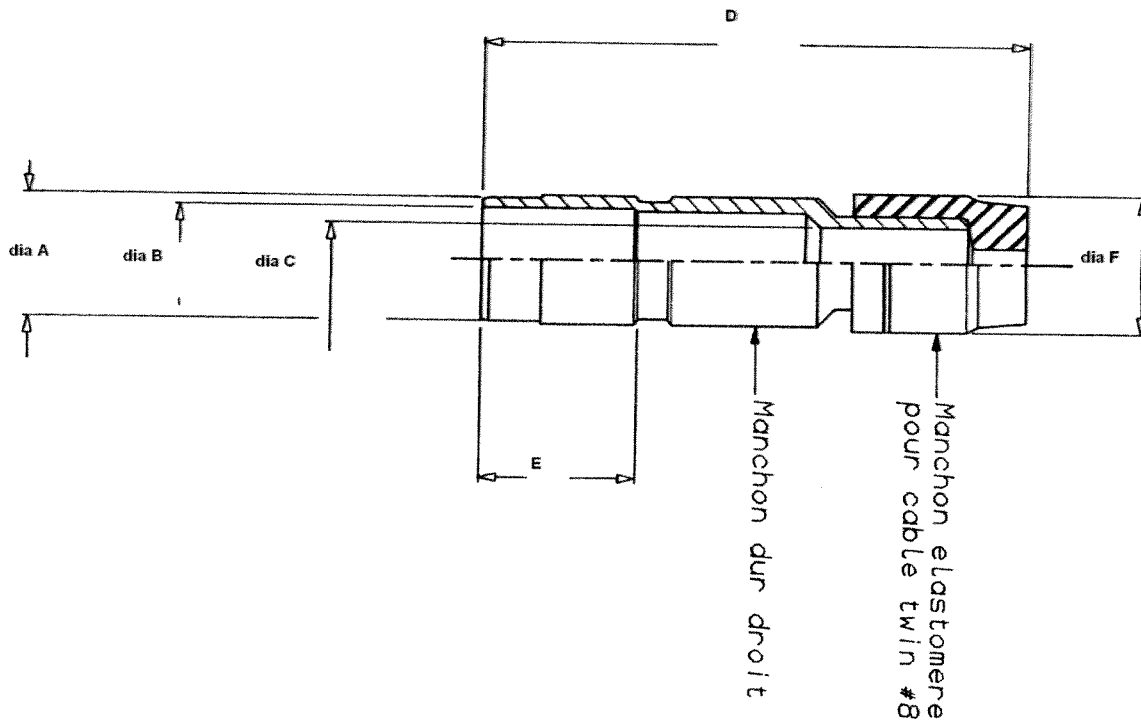

SYMBOL	MILLIMETRES		REMARKS
	MIN.	MAX.	
Ø A	8.30	8.40	
Ø B	7.05	7.15	
Ø C	4.80	4.90	
D	35.40	36.50	
E	10.30	10.50	
Ø F	9.2	9.5	

VARIANT 04, ELBOW SLEEVE

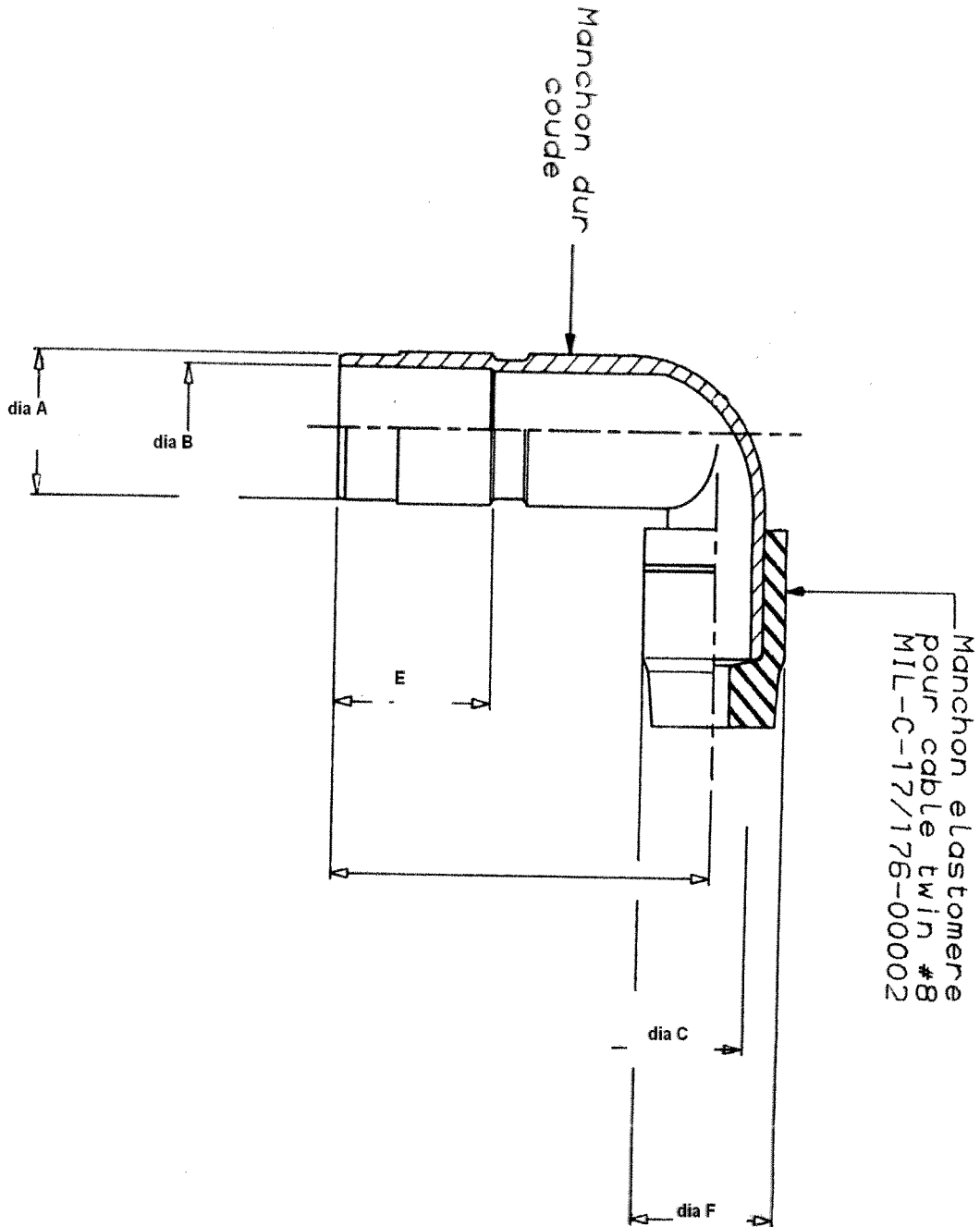

SYMBOL	MILLIMETRES		REMARKS
	MIN.	MAX.	
Ø A	8.30	8.40	
Ø B	7.05	7.15	
Ø C	4.80	4.90	
D	25.00	25.20	
E	10.30	10.50	
Ø F	9.20	9.50	